

**OWNERS DEDICATION**

We, Smart Ltd., a Maryland corporation by John N. Smart, President, and Mary P. Connelly, Secretary, owner of the property shown hereon, hereby adopt this plat of subdivision, dedicate the streets to public use, establish and grant to Montgomery County, Maryland, temporary slope easements twenty-five (25) feet wide over the parcels included hereon, adjacent, contiguous, and parallel to the street lines, the slope easements shall be extinguished after all required public improvements in adjacent roadways have been accepted for maintenance by Montgomery County, or other appropriate agency, establish the minimum building restriction lines, hereby grant a ten (10) foot Public Utilities Easement (P.U.E.) shown hereon to the parties named in a document entitled "Terms and Provisions of Public Easements" as recorded in Liber 3834 at Folio 457 among the Land Records of Montgomery County, Maryland subject to all current and applicable regulations of all federal, state, and local governing agencies, grant to Montgomery County, Maryland, storm drain easements as shown hereon.

There are no suits, actions at law, liens, leases, mortgages, or trusts affecting the property included in this plat of subdivision except a certain deed of trust and the parties in interest thereto have affixed their signatures below indicating their assent.

2/17/86 Mary P. Connelly John N. Smart  
 Date Mary P. Connelly, Secretary John N. Smart, President  
 SMART LTD.

We hereby assent to this plan of subdivision.  
 CHESAPEAKE CONFERENCE ASSOCIATION OF SEVENTH DAY ADVENTIST

3/14/86 E. Austin Carlin, Trustee  
 Date E. Austin Carlin, Trustee

MELLON FINANCIAL SERVICES  
2-18-86 Dwight M. Callantine, Trustee Kevin J. Barron, Trustee  
 Date Dwight M. Callantine, Trustee Kevin J. Barron, Trustee  
 P.E.P.CO. F.O.G.I.

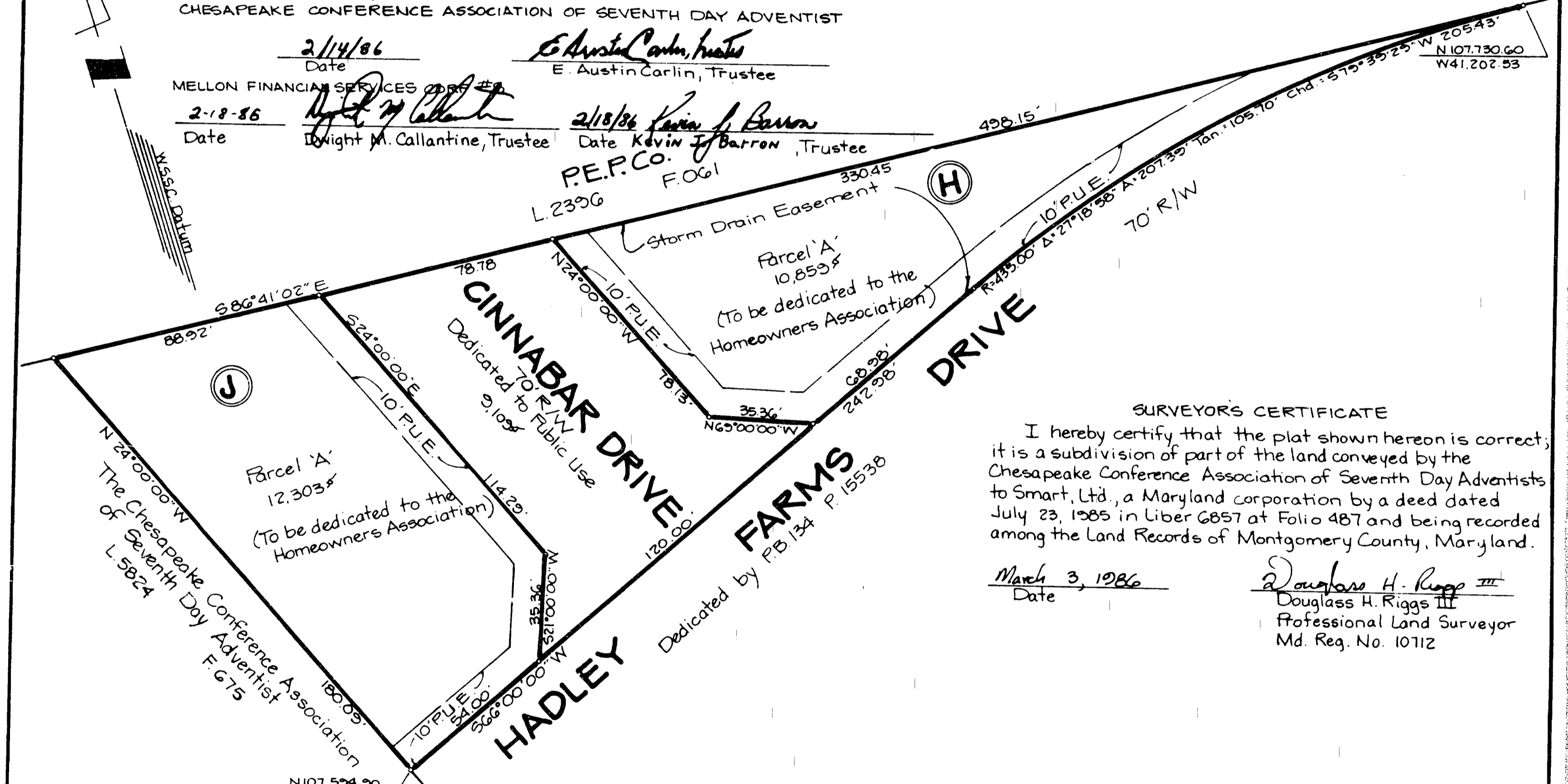
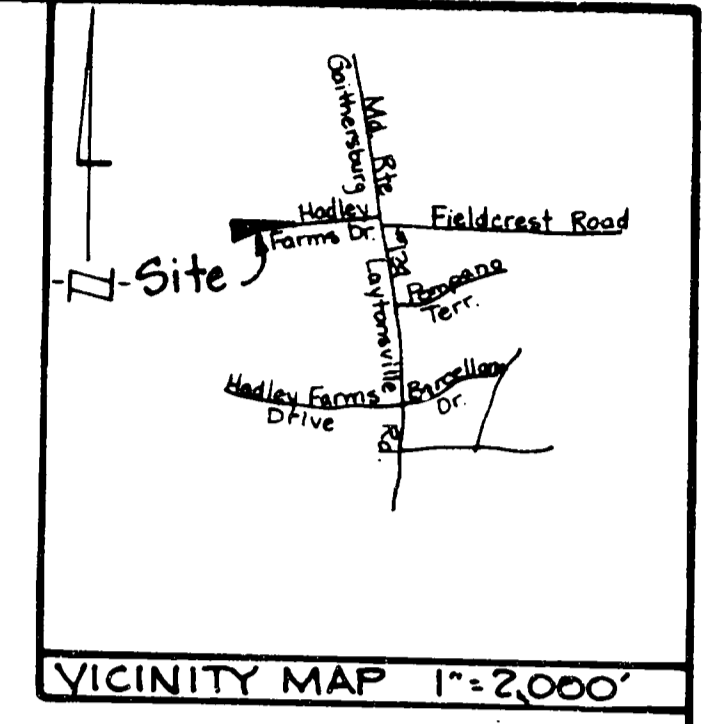

**SURVEYOR'S CERTIFICATE**  
 I hereby certify that the plat shown hereon is correct, it is a subdivision of part of the land conveyed by the Chesapeake Conference Association of Seventh Day Adventists to Smart, Ltd., a Maryland corporation by a deed dated July 23, 1985 in Liber 6857 at Folio 487 and being recorded among the Land Records of Montgomery County, Maryland.

March 3, 1986 Douglas H. Riggs III  
 Date Douglas H. Riggs III  
 Professional Land Surveyor  
 Md. Reg. No. 10712

**PLAT TABULATION**  
 Number of Lots : 0  
 Number of Parcels : 2  
 Area of Parcels : 23,162 sq ft  
 Area of Street Dedication : 9,109 sq ft  
 Total Area : 32,271 sq ft or 0.74065 acres

FILED  
 APR 12 1986  
 FARCEL 'A', BLOCK 'H' and FARCEL 'A', BLOCK 'J'  
**HADLEY FARMS**  
 1st Election District  
 Montgomery County, Maryland  
 Scale: 1"=30' February, 1986

286049 183068 030785 884163 01004730 90 030785 PIA# 86-049

Maryland National Capital Park and Planning Commission Montgomery County Planning Board APPROVED <u>FEBRUARY 20, 1986</u> <u>Dorcas L. Christella</u> Chairman M.N.C.P. & P.C. RECORD FILE No. <u>563-14</u>	Montgomery County, Maryland Department of Transportation APPROVED <u>MARCH 7, 1986</u> <u>Robert Z. Mengman</u> FOR Director	Montgomery County, Maryland Health Department APPROVED <u>MAR 13, 1986</u> <u>Donald A. Gretter, M.D.</u> Health Officer
--	---	---

Macris, Hendricks, & Witmer, P.A.  
 9220 Wightman Road, Suite 220  
 Gaithersburg, Maryland 20879  
 301-670-0840  
 PLAT 7 81-137.3

