

PLAT NO. 14607 BOARD OF EDUCATION
L. 5794 F. 637

Note: Under Provisions of the Montgomery County Code, development of this property has been approved in accordance with Chapter 53-C-1.6, "Development Including Moderately Priced Dwelling Units" and moderately priced units are being provided in conformance with the requirements of Chapter 25-A.

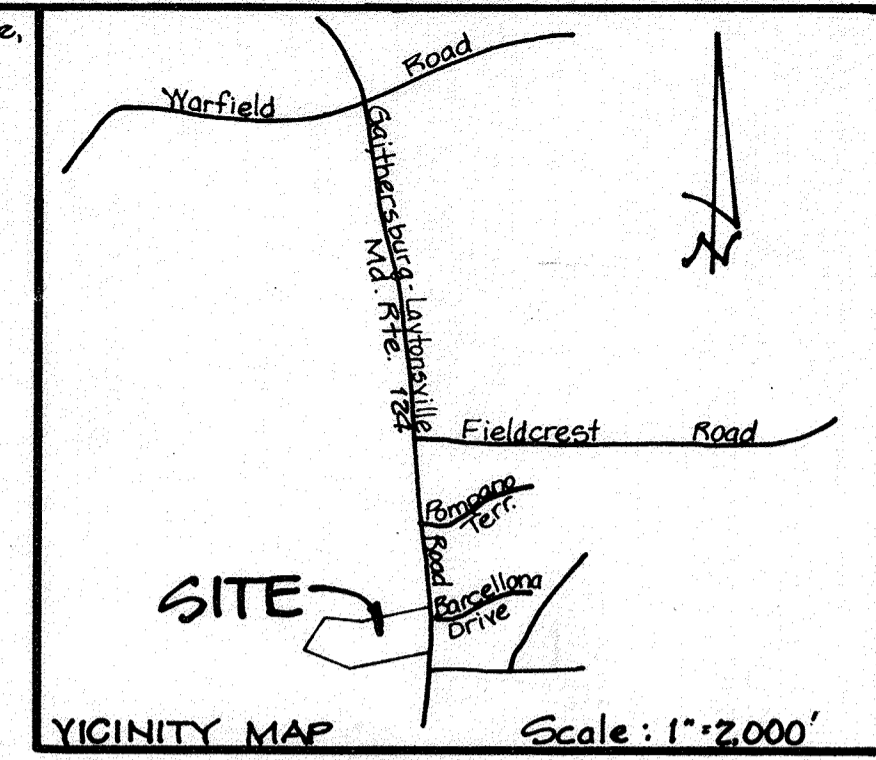
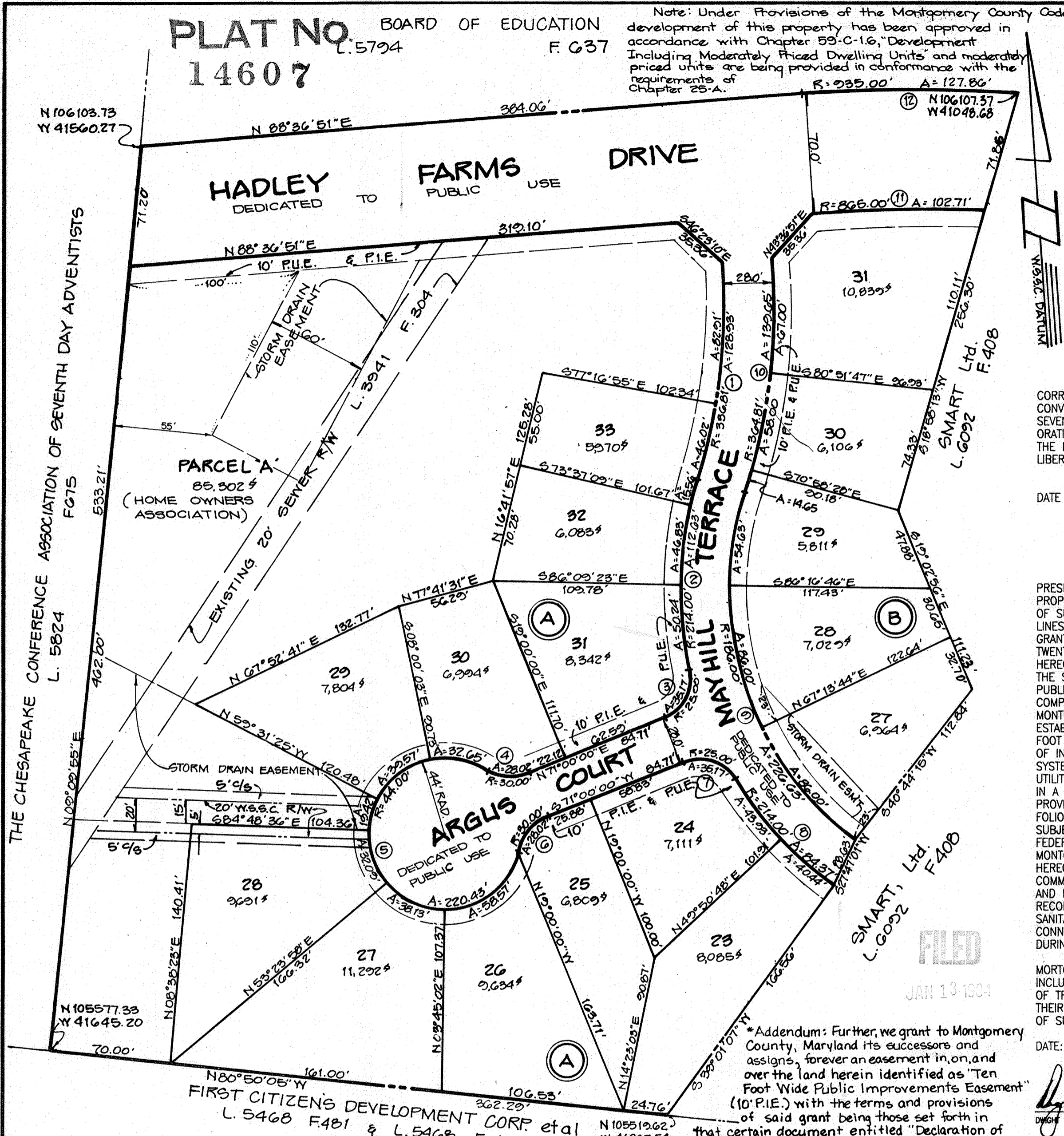

SURVEYOR'S CERTIFICATE

I HEREBY CERTIFY THAT THE PLAN SHOWN HEREON IS CORRECT; THAT IT IS A SUBDIVISION OF PART OF THE LAND CONVEYED BY THE CHESAPEAKE CONFERENCE ASSOCIATION OF SEVENTH DAY ADVENTISTS TO SMART, LTD. A MARYLAND CORPORATION, BY DEED DATED MAY 31, 1983 AND RECORDED AMONG THE LAND RECORDS OF MONTGOMERY COUNTY, MARYLAND IN LIBER 6092 AT FOLIO 408.

DATE Oct. 27, 1983
Douglas H. Riggs III
DOUGLASS H. RIGGS, III
PROFESSIONAL LAND SURVEYOR MD.#10712

OWNER'S DEDICATION

WE, SMART, LTD. A MARYLAND CORPORATION, BY JOHN N. SMART PRESIDENT AND MARY P. CONNELLY, SECRETARY OWNERS OF THE PROPERTY SHOWN AND DESCRIBED HEREON; HEREBY ADOPT THIS PLAN OF SUBDIVISION; ESTABLISH THE MINIMUM BUILDING RESTRICTION LINES; DEDICATE THE STREETS TO PUBLIC USE; ESTABLISH AND GRANT TO MONTGOMERY COUNTY, MARYLAND TEMPORARY SLOPE EASEMENTS TWENTY-FIVE (25) FEET WIDE OVER THE LOTS AND OUTLOTS INCLUDED HEREON, ADJACENT, CONTIGUOUS AND PARALLEL TO THE STREET LINES, THE SLOPE EASEMENTS SHALL BE EXTINGUISHED AFTER ALL REQUIRED PUBLIC IMPROVEMENTS IN ADJACENT ROADWAYS HAVE BEEN LAWFULLY COMPLETED AND HAVE BEEN ACCEPTED FOR MAINTENANCE BY MONTGOMERY COUNTY OR OTHER APPROPRIATE PUBLIC AGENCY; ESTABLISH AND GRANT TO MONTGOMERY COUNTY, MARYLAND TEN (10) FOOT PUBLIC IMPROVEMENTS EASEMENTS (P.I.E.) AS SHOWN FOR PURPOSES OF INSTALLATION, MAINTENANCE, AND OPERATION OF STORM DRAIN SYSTEMS AND APPURTENANCES; HEREBY GRANT TEN (10) FOOT PUBLIC UTILITIES EASEMENTS (P.U.E.) AS SHOWN TO THE PARTIES NAMED IN A DOCUMENT ENTITLED "DECLARATION OF TERMS AND PROVISIONS OF PUBLIC EASEMENT" RECORDED IN LIBER 3834 AT FOLIO 457 OF THE MONTGOMERY COUNTY, MARYLAND LAND RECORDS SUBJECT TO ALL CURRENT AND APPLICABLE REGULATIONS OF ALL FEDERAL, STATE, AND LOCAL GOVERNING AGENCIES; GRANT TO MONTGOMERY COUNTY, MARYLAND, STORM DRAIN EASEMENTS SHOWN HEREON; AND HEREBY GRANT TO THE WASHINGTON SUBURBAN SANITARY COMMISSION THE TEN (10) FOOT PUBLIC UTILITIES EASEMENT (P.U.E.) AND EASEMENTS SHOWN HEREON FOR THE PURPOSES OF CONSTRUCTION, RECONSTRUCTION, INSTALLATION, OPERATION, AND MAINTENANCE OF SANITARY SEWER AND WATER LINES, APPURTENANCES AND HOUSE CONNECTIONS, AND ALSO THE CONSTRUCTION STRIP AS SHOWN, DURING THE PERIOD OF ORIGINAL CONSTRUCTION. *

THERE ARE NO SUITS, ACTIONS AT LAW, LIENS, LEASES, MORTGAGES, TRUSTS OR EASEMENTS AFFECTING THE PROPERTY INCLUDED IN THIS PLAN OF SUBDIVISION, EXCEPT A CERTAIN DEED OF TRUST, AND THE PARTIES IN INTEREST THERETO HAVE AFFIXED THEIR SIGNATURES BELOW INDICATING THEIR ASSENT TO THIS PLAN OF SUBDIVISION.

DATE: 10/11/83 ATTEST: Mary P. Connelly BY: John N. Smart
MARY P. CONNELLY (SECRETARY) JOHN N. SMART (PRESIDENT)

WE HEREBY ASSENT TO THIS PLAN OF SUBDIVISION
Dwight M. Callantine TRUSTEE
CHESAPEAKE CONFERENCE ASSOCIATION SEVENTH DAY ADVENTISTS

Julia F. Gatlin TRUSTEE
E. AUSTIN CARLIN (TRUSTEE)

LOTS 23 THRU 33 BLOCK A
LOTS 27 THRU 31 BLOCK B
and PARCEL "A" Block A

HADLEY FARMS

1ST ELECTION DISTRICT
MONTGOMERY COUNTY, MARYLAND
SEPTEMBER 1983 SCALE 1"=50'
MACRIS, HENDRICKS AND WITMER P.A.
ENGINEERS SURVEYORS
15209 FREDERICK ROAD
ROCKVILLE, MARYLAND 20850
(301) 340 - 8705

PLAT TABULATION

NUMBER OF LOTS	=	16
AREA OF LOTS	=	2,859.61 ACRES
AREA OF PARCELS	=	1,950.26 ACRES
AREA OF STREET DEDICATION	=	1.31354 ACRES
TOTAL AREA OF PLAT	=	0.13141 ACRES

CURVE DATA

Nº	Radius	Delta	Arc	Tan.	Chd. Brg.	Chord
1	336.81'	21°56'00"	128.93'	68.27'	N02°34'51"E	128.15'
2	214.00'	30°08'22"	112.63'	51.65'	N05°28'10"E	111.34'
3	25.00'	80°36'31"	35.17'	21.20'	S30°41'45"W	32.34'
4	30.00'	52°30'59"	28.02'	15.13'	N82°14'31"W	27.01'
5	44.00'	20°01'57"	22.043'	32.54'	N10°00'00"W	52.32'
6	30.00'	53°30'59"	28.02'	15.13'	N44°14'31"E	27.01'
7	25.00'	80°36'31"	35.17'	21.20'	S30°41'45"E	32.34'
8	214.00'	22°35'29"	84.37'	42.74'	N39°41'11"W	83.85'
9	186.00'	22°48'36"	226.63'	129.78'	S14°21'27"E	212.87'
10	364.81'	21°56'00"	139.65'	70.65'	S09°34'51"W	138.80'
11	865.00'	06°48'12"	102.71'	51.42'	S87°59'03"E	102.65'
12	235.00'	07°50'07"	127.86'	64.03'	S87°28'06"E	127.76'

FOR PUBLIC WATER AND SEWER ONLY
MONTGOMERY COUNTY, MARYLAND
DEPT. OF TRANSPORTATION
APPROVED DECEMBER 23, 1983
DATE
Robert B. Memphis
FOR DIRECTOR

MARYLAND NATIONAL CAPITAL PARK AND PLANNING COMMISSION
MONTGOMERY COUNTY PLANNING BOARD
APPROVED NOVEMBER 17, 1983
DATE
Thomas L. Cristeller
CHAIRMAN
SEC. - TREAS.
M.N.C.P. & P.C. RECORD FILE NO. 551-68

RECORDED:
PLAT BOOK:
PLAT NO:
283471821928830500100473090

MONTGOMERY COUNTY CIRCUIT COURT (Subdivision Plats, MO) Plat 14607, MSA_S1249_2012 Date available 19840713 Printed 02/17/2017 Maryland State Archives

H-1000H

551-68